

NOTE :
WRITTEN DIMENSIONS ON THESE DRAWINGS SHALL HAVE PRECEDENCE OVER SCALED DIMENSIONS. CONTRACTORS SHALL VERIFY AND BE RESPONSIBLE FOR ALL DIMENSIONS AND CONDITIONS ON THE JOB. THE DESIGNER MUST BE NOTIFIED IMMEDIATELY OF ANY VARIATIONS FROM THE DIMENSIONS AND CONDITIONS SHOWN BY THESE DRAWINGS.

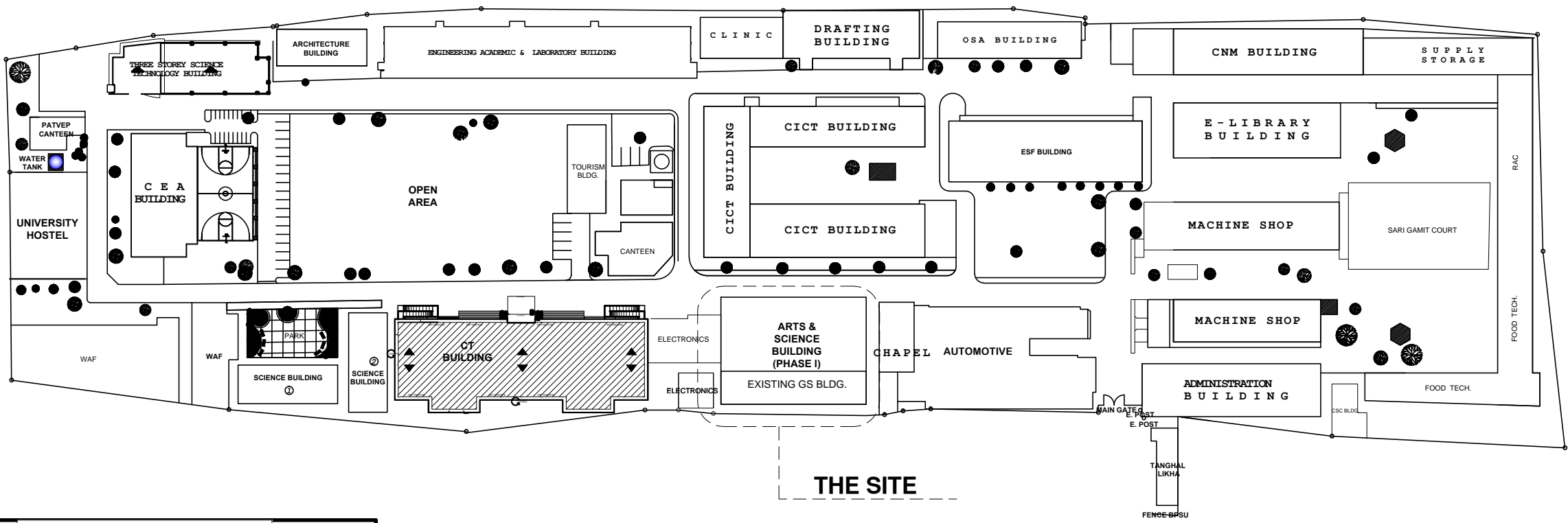

A PERSPECTIVE
A-GS2-00 A-GS2-00 SCALE : NTS



A SITE DEVELOPMENT PLAN
A-GS2-00 A-GS2-00 SCALE : NTS

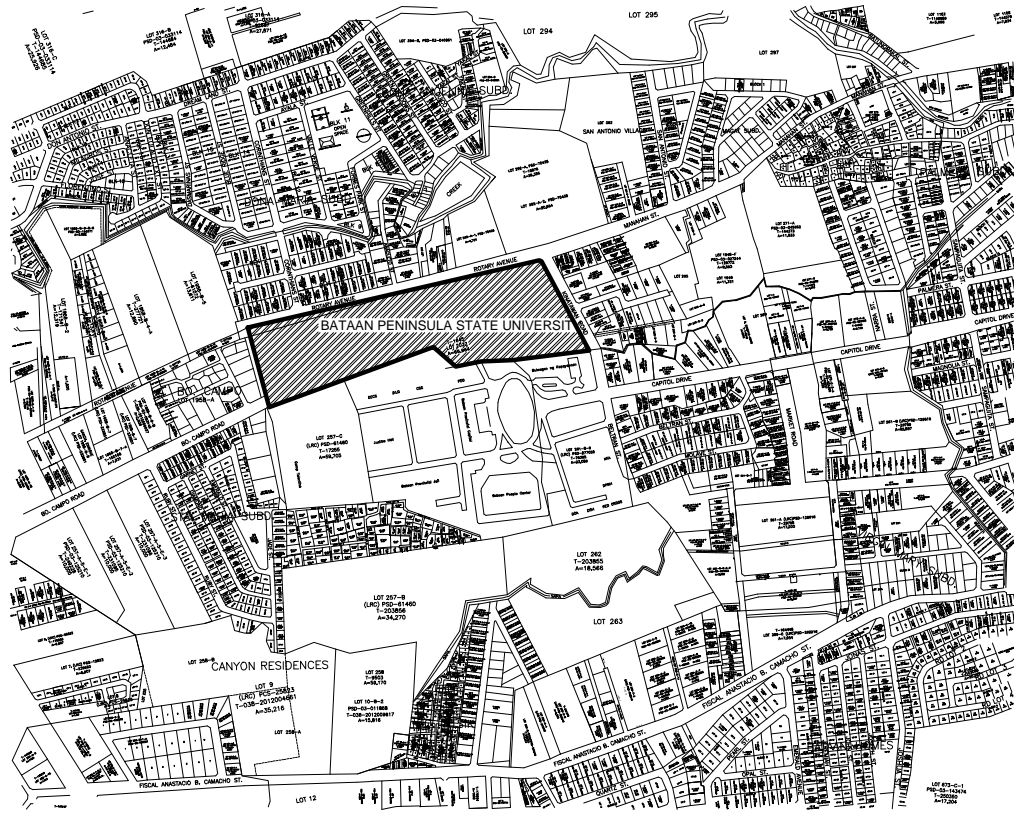

A VICINITY MAP
A-GS2-00 A-GS2-00 SCALE : NTS

SCHEDULE SHEET	REPUBLIC OF THE PHILIPPINES DEPARTMENT OF PUBLIC WORKS & HIGHWAYS OFFICE OF THE BUILDING OFFICIAL	PROJECT TITLE REHABILITATION OF GRADUATE STUDIES BUILDING TO ARTS & SCIENCES BLDG. PHASE II
ARCHITECTURAL	DISTRICT/CITY/MUNICIPALITY	LOCATION:
SHEET NUMBER		BATAAN PENINSULA STATE UNIVERSITY (MAIN CAMPUS) CAPITOL COMPOUND, CITY OF BALANGA, BATAAN
A-GS2-00	LAND USE & ZONING	STRUCTURAL ENGINEER
		REG. NO. :
		PTB. NO. :
		PLACE :
		TIN NO. :
		MASTER PLUMBER/SANITARY ENGINEER
		REG. NO. :
		PTB. NO. :
		PLACE :
		TIN NO. :
		PROFESSIONAL ELECTRICAL ENGINEER
		REG. NO. :
		PTB. NO. :
	LINE & GRADE	PLACE :
		TIN NO. :
		PROFESSIONAL MECHANICAL ENGINEER
		REG. NO. :
		PTB. NO. :
		PLACE :
		TIN NO. :
		REVISION
		NO. DESCRIPTION DATE
		1
		2
		PREPARED BY:
	ARCHITECTURAL	AR. ROXETTE S. UMEREZ
		ARCHITECT 1, BPSU TUG
		REG. NO. :
		PTB. NO. :
		PLACE :
		TIN NO. :
		CHECKED BY:
		AR. JO-ANA MARI Z. TANEGA
		ARCHITECT 1, PPES OFFICE
		REG. NO. :
		PTB. NO. :
		PLACE :
	STRUCTURAL	NOTED BY:
		DR. ALFREDO D. VALENTOS
		DIRECTOR OF PPES OFFICE
		RECOMMENDED BY:
		DR. EDMUNDO C. TUNGOL
		VICE PRESIDENT ADMIN. & FINANCE
		APPROVED BY:
		DR. GREGORIO J. RODIS
		UNIVERSITY PRESIDENT
		REPUBLIC ACT 9266.
		NOTE: THIS DRAWING, AS AN INSTRUMENT OF SERVICE IS THE PROPERTY OF : BATAAN PENINSULA STATE UNIVERSITY AND AS SUCH MUST NOT BE REPRODUCED OR COPIED IN PART OR IN WHOLE WITHOUT THEIR PERMISSION ALL DRAWINGS ARE TO BE RETURNED WHEN NO LONGER IN USE.
		SHEET CONTENT: SHEET NUMBER:
	SANITARY	GROUND FLOOR PLAN
		A-GS2-01
		ELECTRONICS



BATAAN PENINSULA STATE UNIVERSITY
TECHNICAL WORKING GROUP FOR INFRASTRUCTURE
CAPITOL COMPOUND, BPO, TENEJERO, CITY OF BALANGA, BATAAN,
E-MAIL: bpsu.tginfra2016@gmail.com/ bpsuppes2017@gmail.com
TELEPHONE NO. : (047) 237-15-98