

NOTE: DIMENSIONS ON THESE DRAWINGS SHALL HAVE PRECEDENCE OVER SCALED DIMENSIONS. CONTRACTORS SHALL VERIFY AND BE RESPONSIBLE FOR ALL DIMENSIONS AND CONDITIONS ON THE JOB. THE DESIGNER MUST BE NOTIFIED IMMEDIATELY OF ANY VARIATIONS FROM THE DIMENSIONS AND CONDITIONS SHOWN BY THESE DRAWINGS.

NOTE: DISCREPANCY ON ALL DRAWINGS & SPECIFICATIONS (ARCHITECTURAL, STRUCTURAL, SANITARY, ELECTRICAL, MECHANICAL ETC.) SHALL BE SUBJECT FOR VERIFICATION AND NOT SCALE!

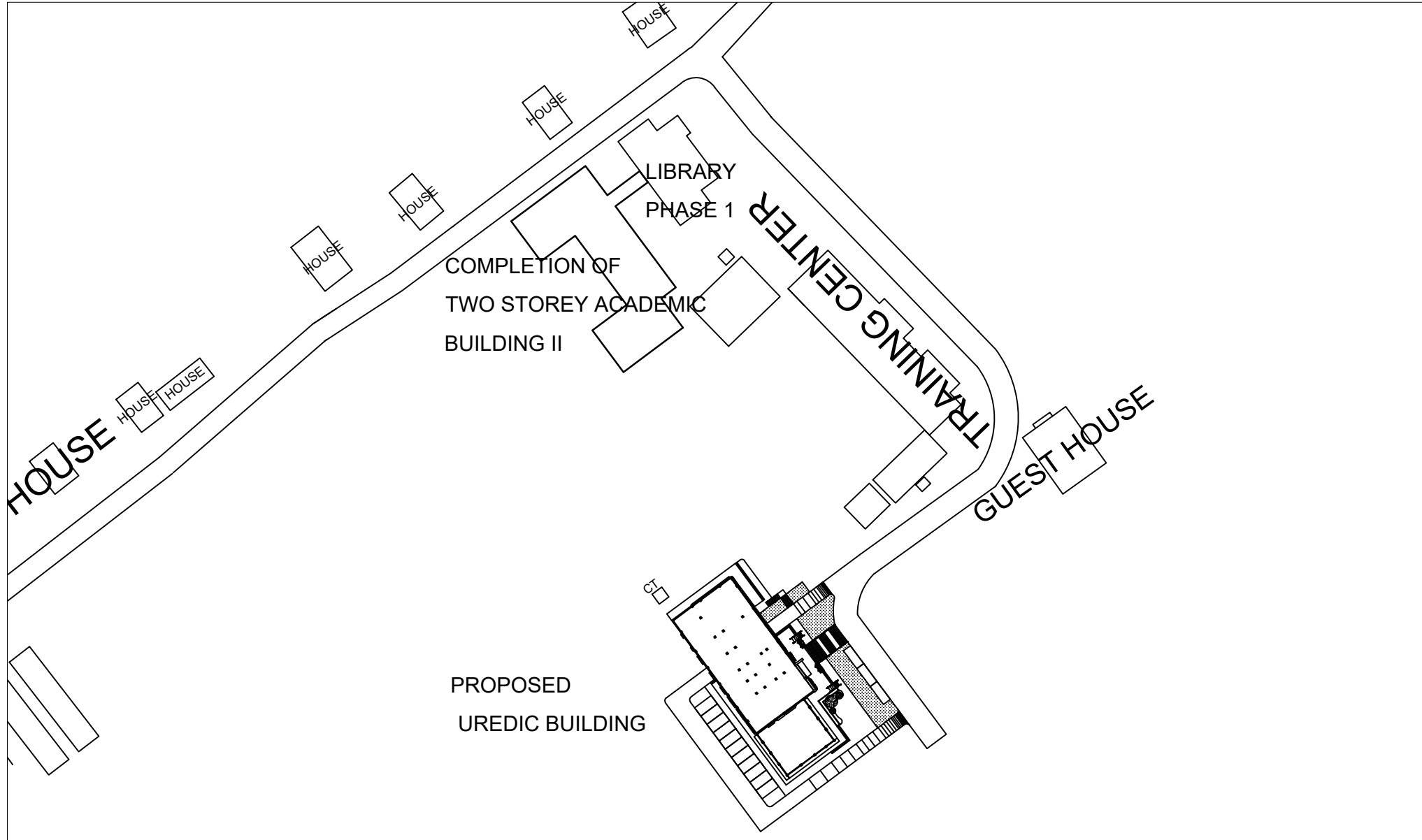

2 LOCATION MAP
A 2 SCALE NTS

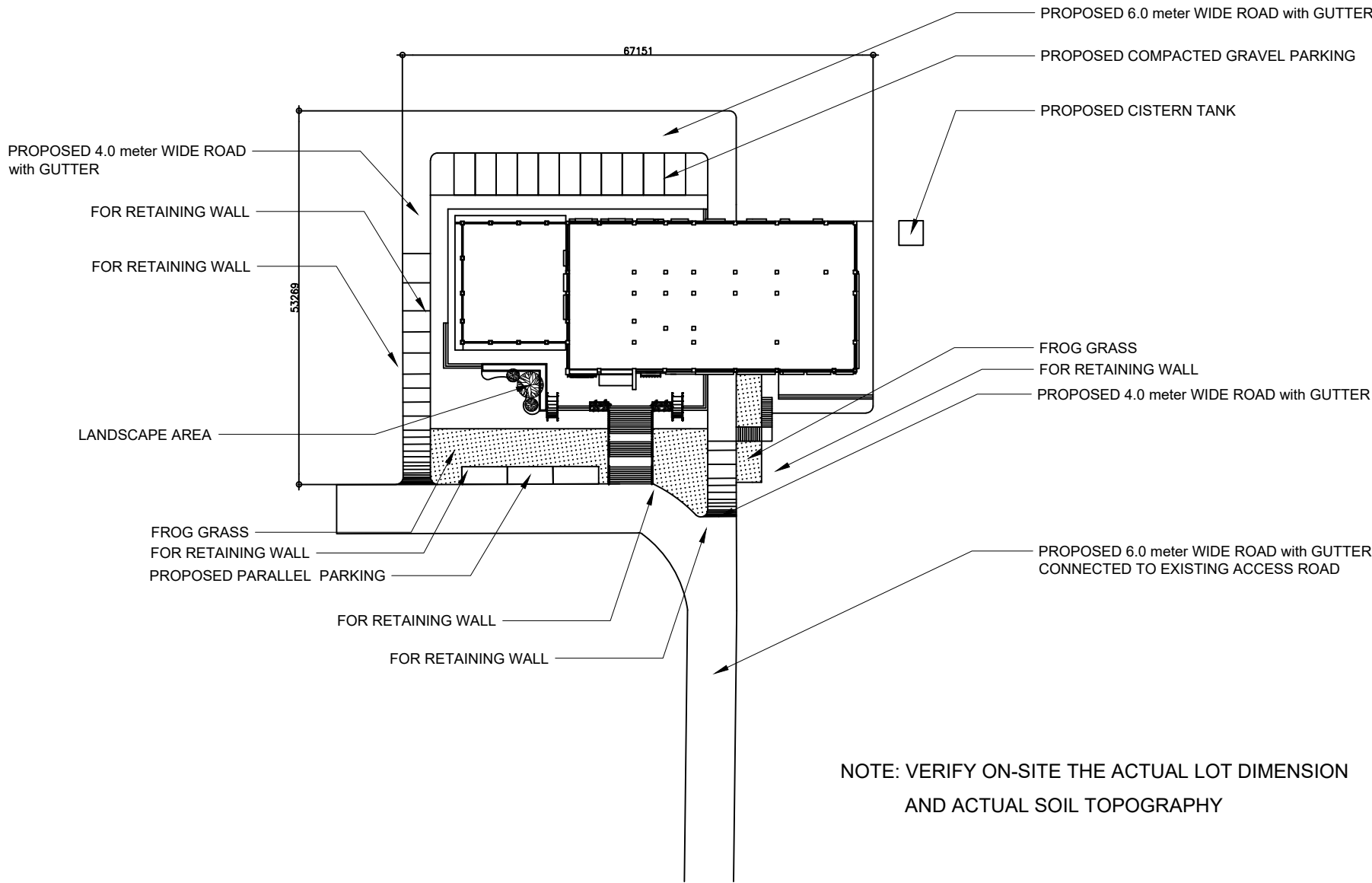

2 SITE DEVELOPMENT PLAN
A 2 SCALE 1:800 MTS

NOTE: VERIFY ON-SITE THE ACTUAL LOT DIMENSION AND ACTUAL SOIL TOPOGRAPHY

PROJECT TITLE:
CONSTRUCTION OF UNIVERSITY RESEARCH, EXTENSION AND DEVELOPMENT INNOVATION CENTER AT ABUCAY CAMPUS

LOCATION:
BATAAN PENINSULA STATE UNIVERSITY (ABUCAY CAMPUS)
ABUCAY, BATAAN

STRUCTURAL ENGINEER
REG. NO. :
PTR. NO. :
PLACE :
TIN NO. :

MASTER PLUMBER/SANITARY ENGINEER
REG. NO. :
PTR. NO. :
PLACE :
TIN NO. :

PROFESSIONAL ELECTRICAL ENGINEER
REG. NO. :
PTR. NO. :
PLACE :
TIN NO. :

PROFESSIONAL MECHANICAL ENGINEER
REG. NO. :
PTR. NO. :
PLACE :
TIN NO. :

| REVISION | | |
|----------|-------------|------|
| NO. | DESCRIPTION | DATE |
| 2 | | |

PREPARED BY:

AR. ROXETTE S. UMEREZ
ARCHITECT 1, BPSU TWG
REG. NO. :
PTR. NO. :
PLACE :

CHECKED BY:

AR. JO-ANA MARI Z. TANEGA
ARCHITECT 1, PPES OFFICE
REG. NO. :
PTR. NO. :
PLACE :

NOTED BY:

ENGR. ALFREDO D. VALENTOS
DIRECTOR, PPES

RECOMMENDED BY:

DR. EDMUNDO C. TUNGOL
VICE PRESIDENT ADMIN. & FINANCE

APPROVED BY:

DR. GREGORIO J. RODIS
UNIVERSITY PRESIDENT

REPUBLIC ACT 9266.
NOTE: THIS DRAWING, AS AN INSTRUMENT OF SERVICE, IS THE PROPERTY OF : BATAAN PENINSULA STATE UNIVERSITY AND AS SUCH MUST NOT BE REPRODUCED OR COPIED IN PART OR IN WHOLE WITHOUT THEIR PERMISSION ALL DRAWINGS ARE TO BE RETURNED WHEN NO LONGER IN USE,

SHEET CONTENT:
• LOCATION MAP
• SITE DEVELOPMENT PLAN

SHEET NUMBER:
A2

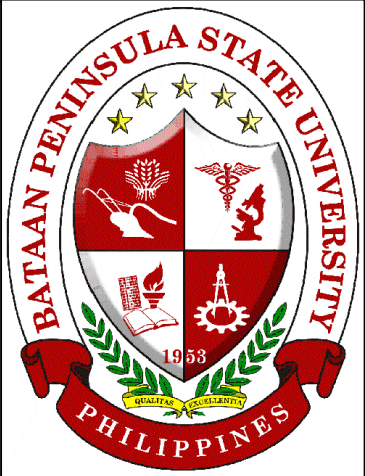

BATAAN PENINSULA STATE UNIVERSITY
TECHNICAL WORKING GROUP FOR INFRASTRUCTURE
CAPITOL COMPOUND, BRGY. TENEJERO, CITY OF BALANGA, BATAAN,
E-MAIL: bpsu.twgr2016@gmail.com/ bpsupes2017@gmail.com
TELEPHONE NO. : (047) 237-15-98

| FLOOR FINISH SCHEDULE (FOR ARCHITECT'S APPROVAL) | | | WALL FINISH SCHEDULE (FOR ARCHITECT'S APPROVAL) | | | | |
|--|---|--|---|--------------------------|--|--|--|
| FF-1 | 60 x 60 CERAMIC NON-SKID TILES (DARK COLOR) | | WF-1 | SAND BLAST FINISH | | | |
| FF-2 | 60 cm x 60 cm POLISHED CERAMIC TILES | | WF-2 | SEMI-GLOSS LATEX PAINT | | | |
| FF-3 | 30 cm x 30cm NON-SKID CERAMIC TILES (LIGHT COLOR) | | WF-3 | SMOOTH PAINTED FINISH | | | |
| FF-4 | BROAD LOOMS FINISH CARPET | | WF-4 | TADAO ANDO CEMENT FINISH | | | |
| FF-5 | VITRIFIED CERAMIC TILES (WOOD FINISH) | | | | | | |
| FF-6 | 60 x 60 CERAMIC NON-SKID TILES (LIGHT COLOR) | | | | | | |
| FF-7 | 60 x 60 CERAMIC NON-SKID TILES W/ ANTI SLIP THREAD NOSING | | | | | | |
| FF-8 | SMOOTH FINISH CONCRETE | | | | | | |
| | | | | | | | |
| | | | | | | | |