

A GROUND FLOOR PLAN
A-RTDC-01 A-RTDC-01 SCALE : 1:150 MTS.

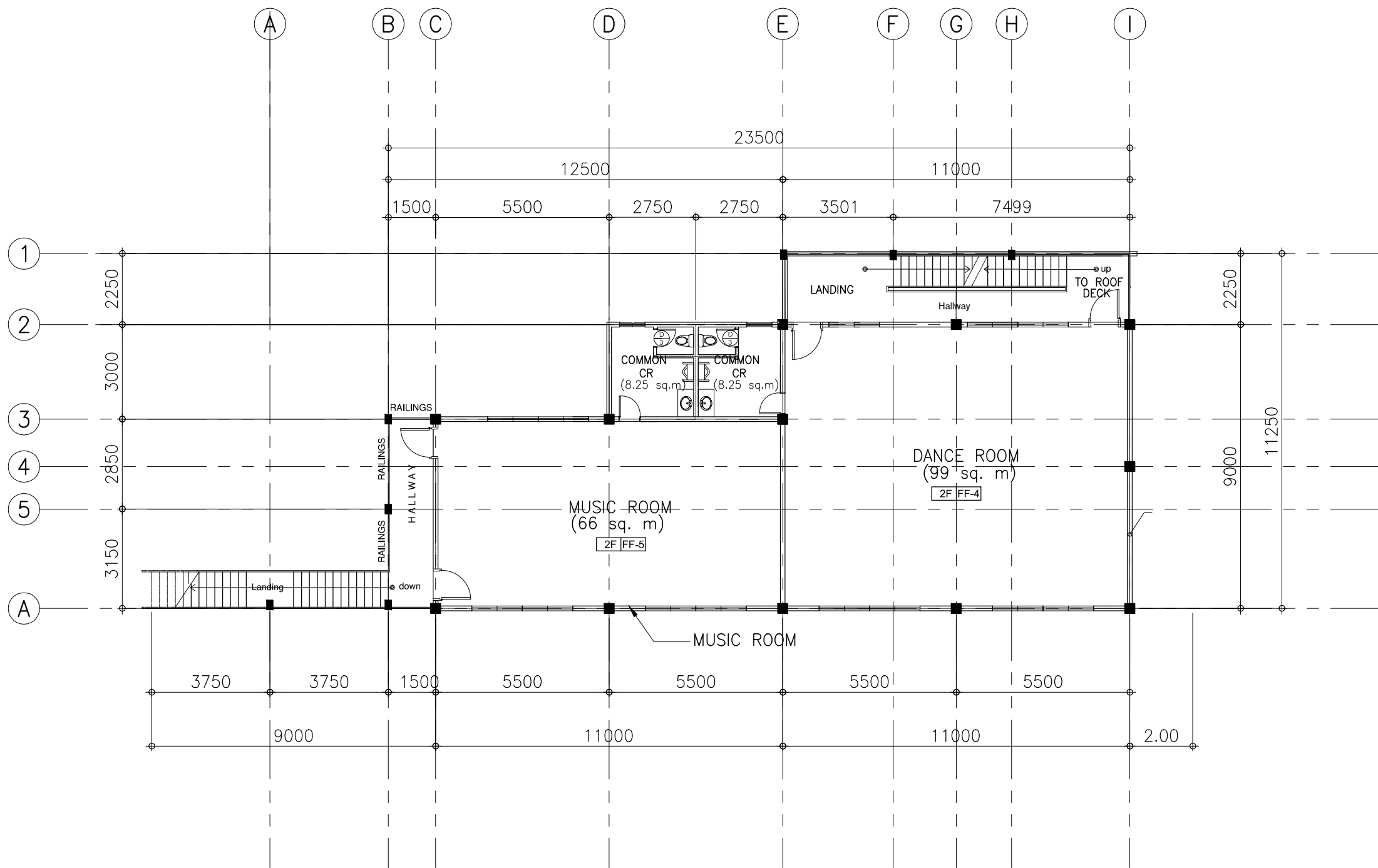

B SECOND FLOOR PLAN
A-RTDC-01 A-RTDC-01 SCALE : 1:150 MTS.

PROJECT TITLE
FLOORING IMPROVEMENT OF
ACAD. BUILDING I & P.E. BLDG
W/ ADDITIONAL SINK FOR
HANDWASHING

LOCATION:
BATAAN PENINSULA STATE UNIVERSITY
DINALUPHAN CAMPUS, DINALUPHAN, BATAAN

STRUCTURAL ENGINEER
REG. NO. :
PTR. NO. :
PLACE :
TN. NO. :

MASTER PLUMBER/SANITARY ENGINEER
REG. NO. :
PTR. NO. :
PLACE :
TN. NO. :

PROFESSIONAL ELECTRICAL ENGINEER
REG. NO. :
PTR. NO. :
PLACE :
TN. NO. :

PROFESSIONAL MECHANICAL ENGINEER
REG. NO. :
PTR. NO. :
PLACE :
TN. NO. :

REVISION		
NO.	DESCRIPTION	DATE
1		
2		

PREPARED BY:

AR. ROXETTE S. UMEREZ
HEAD OF TECHNICAL WORKING GROUP

REG. NO. :
PTR. NO. :
PLACE :
TN. NO. :
REVIEWED BY:

MR. BILLY ALIPIO
CAMPUS DIRECTOR

NOTED BY:

ENGR. ALFREDO D. VALENTOS
DIRECTOR OF PPES

RECOMMENDED BY:

DR. EDMUNDO C. TUNGOL
VICE PRESIDENT ADMIN. & FINANCE

APPROVED BY:

DR. GREGORIO J. RODIS
UNIVERSITY PRESIDENT

REPUBLIC ACT 9266.
NOTE: THIS DRAWING, AS AN INSTRUMENT OF SERVICE
IS THE PROPERTY OF : BATAAN PENINSULA STATE
UNIVERSITY AND AS SUCH MUST NOT BE
REPRODUCED OR COPIED IN PART OR IN WHOLE
WITHOUT THEIR PERMISSION ALL DRAWINGS ARE
TO BE RETURNED WHEN NO LONGER IN USE.

SHEET CONTENT: FLOOR PLAN
SHEET NUMBER: A-RTDC-01



BATAAN PENINSULA STATE UNIVERSITY
TECHNICAL WORKING GROUP FOR INFRASTRUCTURE

CAPITOL COMPOUND, BROY, TENEJERO, CITY OF BALANGA, BATAAN,
E-MAIL: bpsu.teinfra2016@gmail.com/ bpsupes2017@gmail.com
TELEPHONE NO. : (047) 237-15-98

FLOOR FINISH SCHEDULE (FOR ARCHITECT'S APPROVAL)		WALL FINISH SCHEDULE (FOR ARCHITECT'S APPROVAL)		PARTITION SCHEDULE (FOR ARCHITECT'S APPROVAL)	
FF-1	6mm X 600mm x 600mm CERAMIC TILES (DOUBLE COAT)	W-1		P-1	
FF-2	6mm X 600mm x 600mm CERAMIC VITRIFIED TILES (NON-SKID)	W-2		P-2	
FF-3	24mm THK. RUBBER FLOORING	W-3		P-3	
FF-4	7mm THK. TARAFLEX FLOORING	W-4		P-4	
FF-5	ROLLED CARPET(BROADLOOMS)				