

☐ FOR APPROVAL

☐ FOR CONSTRUCTION

☐ AS-BUILT PLAN

PROJECT TITLE:

CONVERSION OF THREE STOREY BUILDING INTO INTERIM BUILDING FOR COLLEGE OF MEDICINE AT BPSU MAIN CAMPUS

LOCATION:

BATAAN PENINSULA STATE UNIVERSITY (MAIN CAMPUS)
BALANGA CITY, BATAAN

STRUCTURAL ENGINEER

REG. NO. 1: _____

PUR. NO. 1: _____

PLANS: _____

END USER: _____

MASTER PLUMBER/SANITARY ENGINEER

REG. NO. 1: _____

PUR. NO. 1: _____

PLANS: _____

END USER: _____

PROFESSIONAL ELECTRICAL ENGINEER

REG. NO. 1: _____

PUR. NO. 1: _____

PLANS: _____

END USER: _____

PROFESSIONAL MECHANICAL ENGINEER

REG. NO. 1: _____

PUR. NO. 1: _____

PLANS: _____

END USER: _____

END USER:

CAMPUS DIRECTOR

PREPARED BY:

AR. SHARON R. BAUTISTA
ARCHITECT

REVIEWED BY:

ENGR. ROY JOSEPH P. ENRIQUEZ
DIRECTOR OF PPES

RECEIVED BY:

PROF. J. GERALD M. GADIA
VICE PRESIDENT ADMIN & FINANCE

APPROVED BY:

DR. RUBY B. SANTOS-MATIBAG
UNIVERSITY PRESIDENT

REPUBLIC ACT 9266.

NOTE: THIS DRAWING, AS AN INSTRUMENT OF SERVICE IS THE PROPERTY OF : BATAAN PENINSULA STATE UNIVERSITY AND AS SUCH MUST NOT BE REPRODUCED OR COPIED IN PART OR IN WHOLE WITHOUT THEIR PERMISSION ALL DRAWINGS ARE TO BE RETURNED WHEN NO LONGER IN USE.

SHEET CONTENT:	SHEET NUMBER:
-GROUND FLOOR POWER LAYOUT	E-3
-SECOND FLOOR POWER LAYOUT	

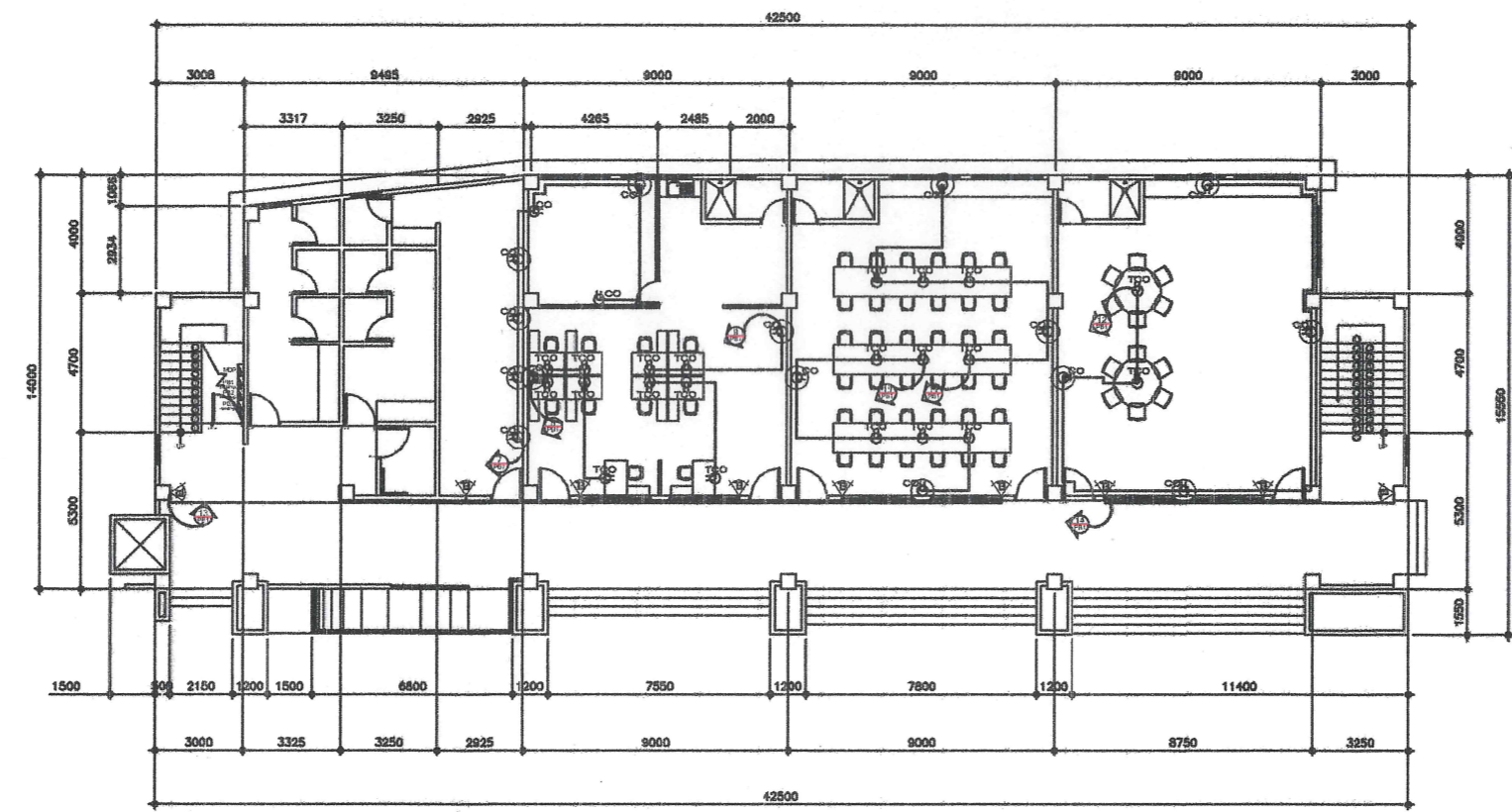

1
GROUND FLOOR
POWER LAYOUT
E-3 SCALE 1:140MTS.

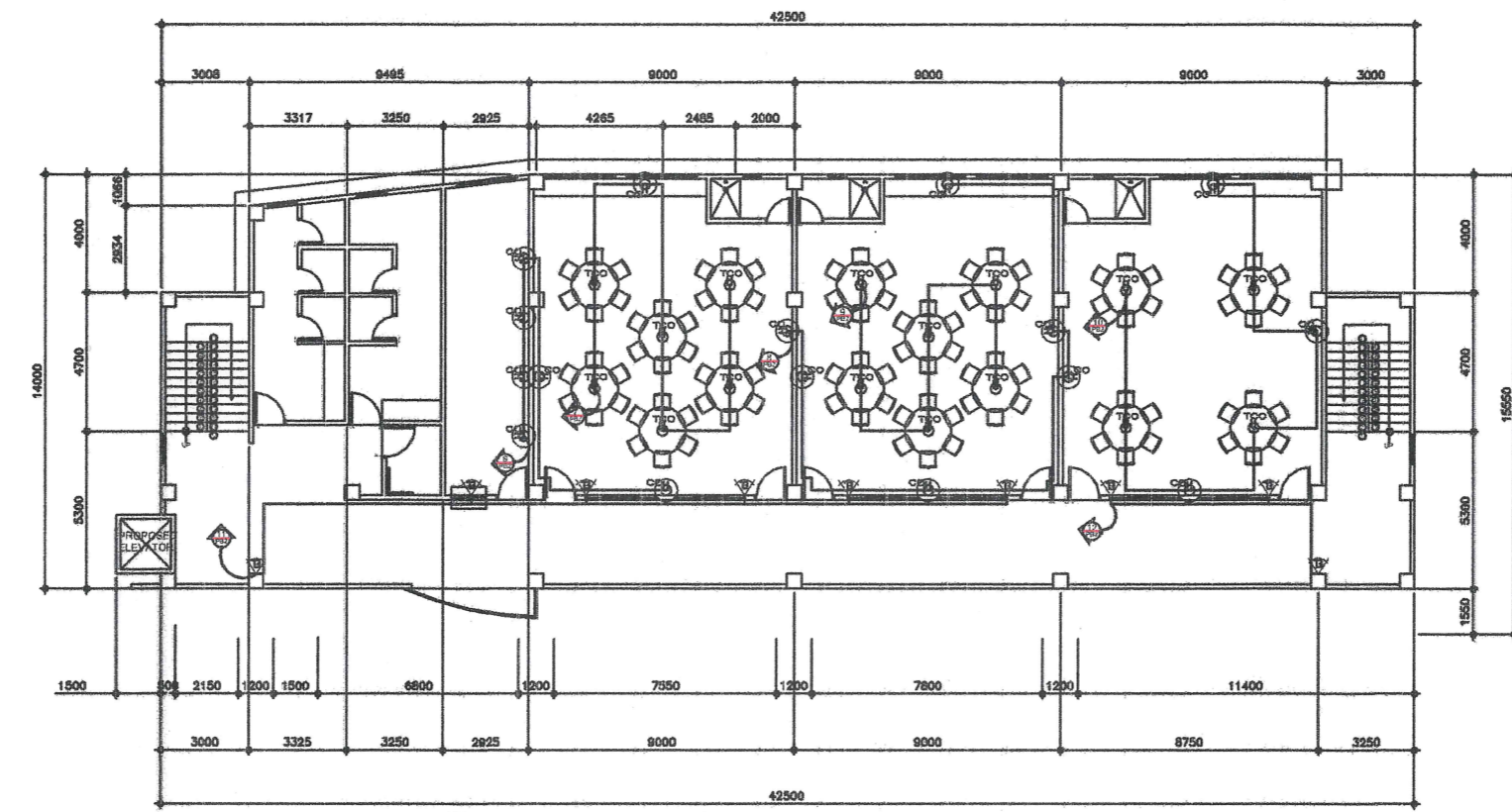

2
SECOND FLOOR
POWER LAYOUT
E-3 SCALE 1:140MTS.

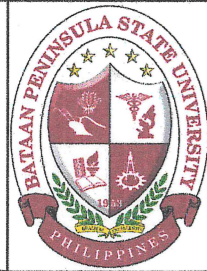

BATAAN PENINSULA STATE UNIVERSITY
TECHNICAL WORKING GROUP FOR INFRASTRUCTURE
CAPTOL COMPOUND, BRGY. TIGESERO, CITY OF BALANGA, BATAAN
E-MAIL: bpsuinfrastructure@gmail.com / bpsuinfrastructure@yahoo.com
TELEPHONE NO.: (047) 257-15-88

NOTE: WRITTEN DIMENSIONS ON THESE DRAWINGS SHALL HAVE PRECEDENCE OVER SCALED DIMENSIONS. CONTRACTORS SHALL VERIFY AND BE RESPONSIBLE FOR ALL DIMENSIONS & SPECIFICATIONS AND COORDINATE WITH THE JOB. THE DESIGNER MUST BE NOTIFIED IMMEDIATELY OF ANY DISCREPANCIES OR OMISSIONS FROM THE DIMENSIONS AND CONDITIONS SHOWN IN THESE DRAWINGS.