

NOTE :
WRITTEN DIMENSIONS ON THESE DRAWINGS SHALL HAVE PRECEDENCE OVER SCALED DIMENSIONS. CONTRACTORS SHALL VERIFY AND BE RESPONSIBLE FOR ALL DIMENSIONS AND CONDITIONS ON THE JOB. THE DESIGNER MUST BE NOTIFIED IMMEDIATELY OF ANY VARIATIONS FROM THE DIMENSIONS AND CONDITIONS SHOWN BY THESE DRAWINGS.

NOTE :
IF IN DOUBT, ASK
DO NOT SCALE!

NOTE :
DISCREPANCY ON ALL DRAWINGS & SPECIFICATIONS
(ARCHITECTURAL, STRUCTURAL, SANITARY, ELECTRICAL,
MECHANICAL, ETC.) SHALL BE SUBJECT FOR VERIFICATION



C
P-DC-00 P-DC-00
PERSPECTIVE
SCALE : NTS

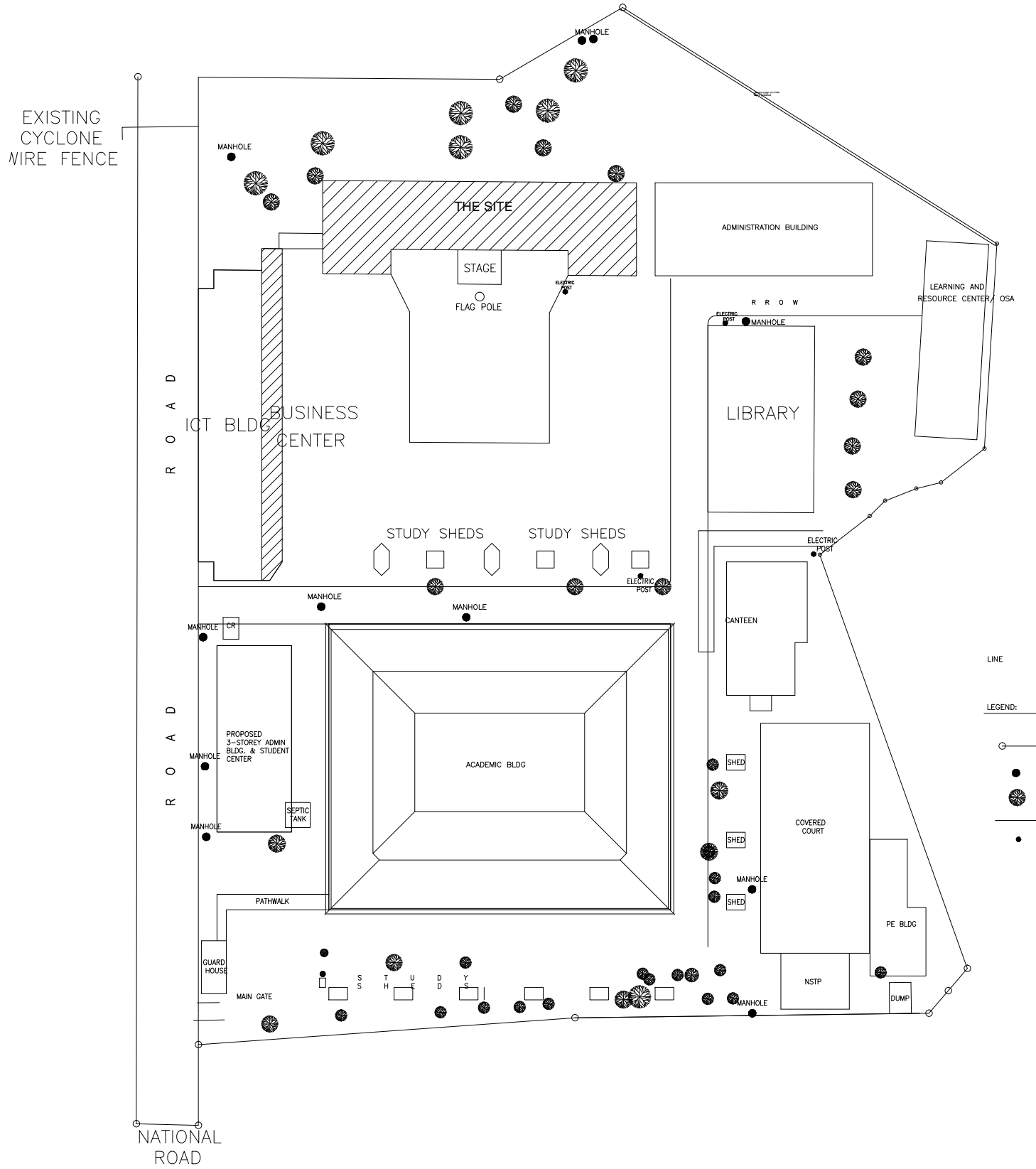

A
P-DC-00 P-DC-00
SITE DEVELOPMENT PLAN
SCALE : NTS

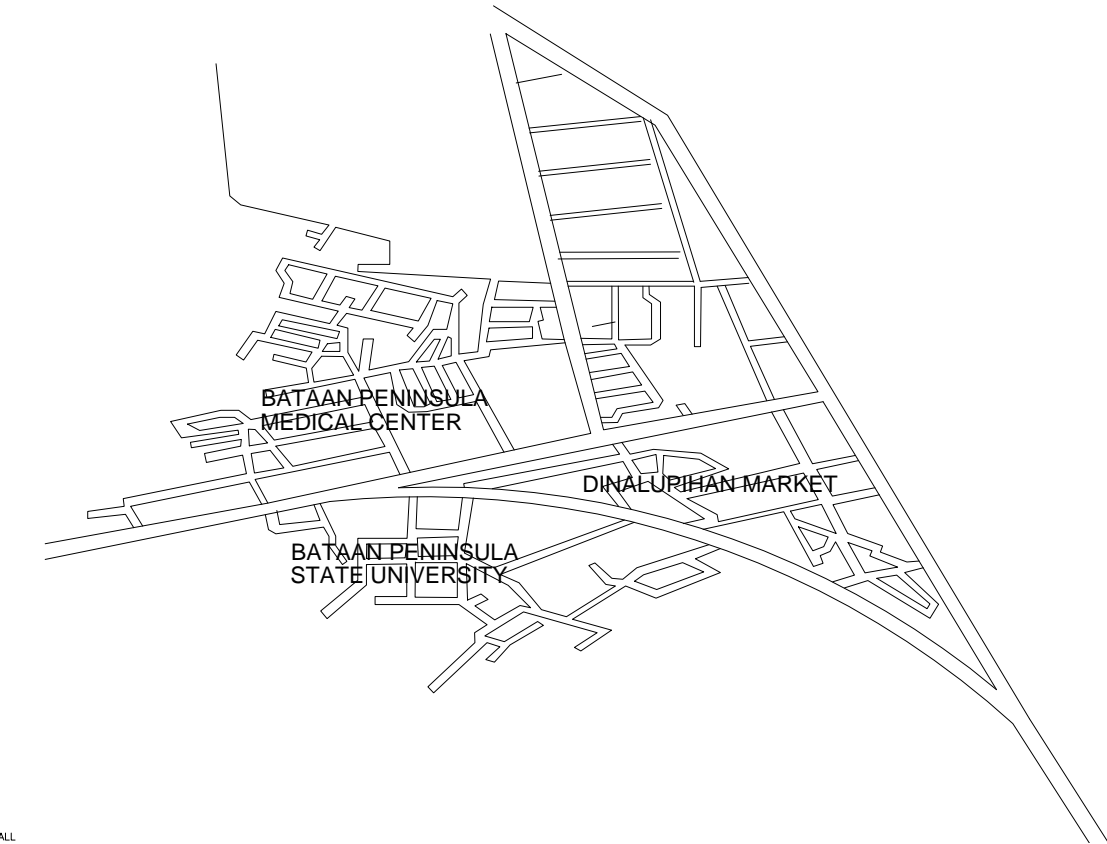

B
P-DC-00 P-DC-00
VICINITY MAP
SCALE : NTS

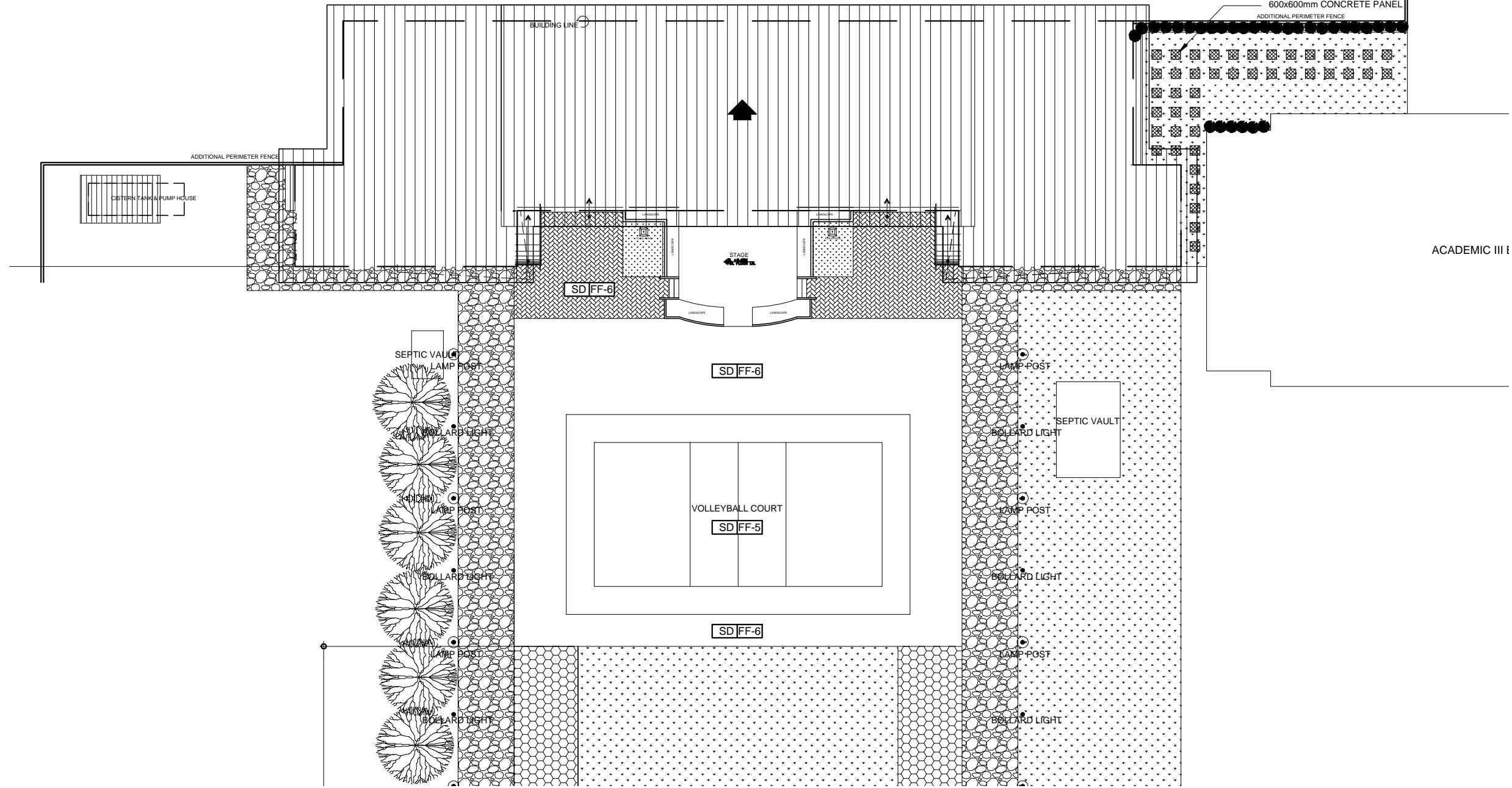

A.1
P-DC-00 P-DC-00
**SHOWING LOCATION OF UTILITIES
SITE DEVELOPMENT PLAN**
SCALE : NTS

SPECIFICATIONS				LEGEND	
PP-R POLYFUSION WELDED POLYPROPYLENE WATER PIPES SIZE AND SPECIFICATION:				SD	SHOWER DRAIN
NOMINAL SIZE	ID	THICKNESS		LAV	LAVATORY
mm	inches	mm		WC	WATER CLOSET
20	3/4	1.75	3.50	FD	FLOOR DRAIN
25	1	2.00	4.00	CO	CLEAN OUT
32	1 1/4	2.50	5.00	UR	URINAL
40	1 1/2	3.00	6.00	WS	WASTE STACK
50	2	3.50	7.00	SS	SOIL STACK
CLASS: PN 20				VS	VENT STACK
CLEANOUT :				VSTR	VENT STACK THRU ROOF
SIZE OF PIPE	SIZE OF CLEAN OUT			VSTC	VENT STACK THRU CEILING
DIAMETER	DIAMETER			CWL	COLD WATER LINE
50 mm	50 mm (1.75)			CWR	COLD WATER RISER
75 mm	75 mm (3.00)			CWDF	COLD WATER DOWN FEED
100 mm	100 mm (4.00)			AC	AIR CHAMBER
125 mm	125 mm (5.00)			KS	SERVICE SINK
150 mm	150 mm (6.00)			TYP	TYPICAL
175 mm	175 mm (7.00)			SMH	SEWER MANHOLE
200 mm	200 mm (8.00)			MH	MANHOLE
225 mm	225 mm (9.00)			CB	CATCH BASIN
250 mm	250 mm (10.00)			GD	GUTTER DRAIN
275 mm	275 mm (11.00)			RD	ROOF DRAIN
300 mm	300 mm (12.00)			TD	TRENCH DRAIN
325 mm	325 mm (13.00)			CWP	COLD WATER PUMP
350 mm	350 mm (14.00)			BP	BOOSTER PUMP
375 mm	375 mm (15.00)			SP	SUMP PUMP
400 mm	400 mm (16.00)			QTY	QUANTITY
425 mm	425 mm (17.00)			TDH	TOTAL DYNAMIC HEAD
450 mm	450 mm (18.00)			HP	HORSE POWER
475 mm	475 mm (19.00)			RPM	REVOLUTION PER MINUTE
500 mm	500 mm (20.00)			KW	KILOWATT
525 mm	525 mm (21.00)				WATER LINE
550 mm	550 mm (22.00)				SOIL PIPE
575 mm	575 mm (23.00)				WASTE PIPE
600 mm	600 mm (24.00)				WATER METER
625 mm	625 mm (25.00)				CHECK VALVE
650 mm	650 mm (26.00)				GATE VALVE
675 mm	675 mm (27.00)				UNION
700 mm	700 mm (28.00)				
725 mm	725 mm (29.00)				
750 mm	750 mm (30.00)				
775 mm	775 mm (31.00)				
800 mm	800 mm (32.00)				
825 mm	825 mm (33.00)				
850 mm	850 mm (34.00)				
875 mm	875 mm (35.00)				
900 mm	900 mm (36.00)				
925 mm	925 mm (37.00)				
950 mm	950 mm (38.00)				
975 mm	975 mm (39.00)				
1000 mm	1000 mm (40.00)				

GENERAL PLUMBING NOTES AND SPECIFICATION :

REF. RA 1378 NATIONAL PLUMBING CODE OF THE PHILS.

- EXECUTION OF PLUMBING WORK**
ALL PLUMBING WORK INCLUDE HEREIN SHALL BE EXECUTED ACCORDING TO THE REQUIREMENT OF THE PHILIPPINE PLUMBING CODE THE RULES AND THE REGULATION OF THE CITY GOVERNMENT, OR MUNICIPALITY
- NOTIFICATION OF ARCHITECT**
COORDINATION WITH DRAWING AND OTHER RELATED SPECIFICATION, THE ARCHITECT SHALL BE NOTIFIED IMMEDIATELY IF ANY DISCREPANCY FOUND THEREIN
- RELOCATION OF PIPES**
PIPES SHALL BE INSTALLED AS INDICATED ANY RELOCATION REQUIREMENT FOR PROPER EXECUTION OF OTHER TRADES SHALL BE WITH PRIOR APPROVAL OF ARCHITECT AND ENGINEER
- SANITARY UTILITIES**
PROPOSE SANITARY UTILITIES SHALL CONFORMED TO THE ACTUAL LOCATION, DEPTH AND INVERTED ELEVATION OF ALL EXISTING PIPES AND STRUCTURE
- FIXTURES**
ALL FIXTURES SHALL BE VENTED UNLESS OTHERWISE INDICATED
- GRADES OF HORIZONTAL PIPING**
RUN ALL HORIZONTAL PIPING PERFECT ALIGNMENT AND AT UNIFORM OF NOT LESS THAN TWO PERCENT (%)
- CHANGE OF DIRECTION**
ALL CHANGE OF DIRECTION SHALL BE MADE BY APPROPRIATE USE OF THE 45° WYES, LONG SWEEP, QUARTER BEND SIXTH OR EIGHTH TO SIXTEENTH BENDS A SINGLE 180° BEND COMBINATION MAY BE USE ON VERTICAL STACK AND SHORT QUARTER BEND MAY BE USE VENT TYPES
- PROHIBITED FITTINGS**
NO DOUBLE HUBS, DOUBLE TEE BRANCH SHALL BE USE ON HORIZONTAL SOIL WASTE LINE, THE DRILLING OR TAPPING OF HOUSE DRAIN WASTE OR VENT PIPES AND SADDLE HUBS AND VENT PROHIBITED
- SLEEVES (NOT APPLICABLE)**
PROVIDE PIPE SLEEVES AT WALLS COLUMN SLAB ONE SLAB ONE BIGGER THAN ACTUAL SIZE PASSING THROUGH WALLS OR SLAB TO PIPES FROM BREAKAGE
- CLEANOUT PIPES**
CLEANOUT ARE REQUIRE UNDER THE FOLLOWING CONDITION:
1. EVERY CHANGE IN HORIZONTAL DIRECTION EXCEEDING 90° OR ONE HALF DEGREES.
2. 1500mm INSIDE THE PROPERTY LINE THE DRAIN CONNECTOR
3. EVERY 1500mm IN HORIZONTAL RUN PIPE
4. AT THE END OF THE HORIZONTAL PIPE LINE
- DEAD END AVOIDED**
A DEAD END IN THE INSTALLATION OF ANY PLUMBING SYSTEM IS PROHIBITED
- NO REVISION IN THE DESIGN SHALL BE DONE WITH OUT THE PROPER KNOWLEDGE AND APPROVAL OF THE DESIGNER AND THE OWNER ANY SUCH REVISION DONE WITHOUT THE APPROVAL SHALL COURSE RESPONSIBILITY OF THE DESIGNER/ARCHITECT TO CEAS A WHOLE**
- NO PIPING WORK FIXTURE OR EQUIPMENT SHALL BE CONCEALED OR COVERED BY ANY MANS BEFORE THEY HAVE BEEN PRESSURE TESTED, FLOW TESTED AND INSPECTED BY THE ARCHITECT HAVING THE JURISDICTION OF THE WORK**
- ALL WORK SHALL BE COMPLETELY INSTALLED AND TESTED AS REQUIRED BY THE SECTION 1378 AND SHALL BE LEAKTIGHT AT 1 G**
- UNLESS OTHERWISE NOTED AND SPECIFIED, USE NELLETEX BRAND TO ALL MATERIALS OF ROUGHING OR AND APPROVED BY EQUIVALENT**

	
BATAAN PENINSULA STATE UNIVERSITY TECHNICAL WORKING GROUP FOR INFRASTRUCTURE	
CAPITOL COMPOUND, BRGY. TENEJERO, CITY OF BALANICA, BATAAN, E-MAIL: bpsu.twginfra2016@gmail.com/ bpsupes2017@gmail.com TELEPHONE NO. : (047) 237-15-98	
ARCHITECTURAL	
SHEET NUMBER	DESCRIPTION
A-DC-00	PERSPECTIVE
	SITE DEVELOPMENT PLAN
	VICINITY MAP
A-DC-01	GROUND FLOOR PLAN
A-DC-02	SECOND FLOOR PLAN
A-DC-03	THIRD FLOOR PLAN
A-DC-04	FOURTH FLOOR PLAN
A-DC-05	ROOF PLAN
A-DC-06	GROUND FLOOR PLAN(RCP)
A-DC-07	SECOND FLOOR PLAN(RCP)
A-DC-08	THIRD FLOOR PLAN(RCP)
A-DC-09	FOURTH FLOOR PLAN(RCP)
A-DC-10	FRONT ELEVATION
	REAR ELEVATION
	LEFT SIDE ELEVATION
	RIGHT SIDE ELEVATION
	SECTION & BLOW-UP DETAILS
A-DC-11	SCHEDULE OF DOORS & WINDOWS
	DETAILS OF PUMP HOUSE

PROJECT TITLE		
REPAIR & REHABILITATION OF ACADEMIC BLDG. II AT DINALUPIHAN CAMPUS		
LOCATION:		
BATAAN PENINSULA STATE UNIVERSITY DINALUPIHAN CAMPUS, DINALUPIHAN, BATAAN		
STRUCTURAL ENGINEER		
REG. NO. :		
PTE. NO. :		
PLACE :		
TIN NO. :		
MASTER PLUMBER/SANITARY ENGINEER		
REG. NO. :		
PTE. NO. :		
PLACE :		
TIN NO. :		
PROFESSIONAL ELECTRICAL ENGINEER		
REG. NO. :		
PTE. NO. :		
PLACE :		
TIN NO. :		
PROFESSIONAL MECHANICAL ENGINEER		
REG. NO. :		
PTE. NO. :		
PLACE :		
TIN NO. :		
REVISION		
NO.	DESCRIPTION	DATE
1		
2		
PREPARED BY:		
AR. ROXETTE S. UMEREZ		
ARCHITECT I, BPSU TWO		
REG. NO. :		
PTE. NO. :		
PLACE :		
TIN NO. :		
REVIEWED BY:		
MR. BILLY ALIPIO		
CAMPUS DIRECTOR		
NOTED BY:		
ENGR. ALFREDO D. VALENTOS		
DIRECTOR OF PPES		
RECOMMENDED BY:		
DR. EDMUNDO C. TUNGOL		
VICE PRESIDENT ADMIN. & FINANCE		
APPROVED BY:		
DR. GREGORIO J. RODIS		
UNIVERSITY PRESIDENT		
REPUBLIC ACT 9266.		
NOTE: THIS DRAWING, AS AN INSTRUMENT OF SERVICE IS THE PROPERTY OF : BATAAN PENINSULA STATE UNIVERSITY AND AS SUCH MUST NOT BE REPRODUCED OR COPIED IN PART OR IN WHOLE WITHOUT THEIR PERMISSION ALL DRAWINGS ARE TO BE RETURNED WHEN NO LONGER IN USE,		
SHEET CONTENT:		SHEET NUMBER:
SITE DEVELOPMENT PLAN VICINITY MAP PERSPECTIVE		P-DC-00