

NOTE : DIMENSIONS ON THESE DRAWINGS SHALL HAVE PRECEDENCE OVER SCALE DIMENSIONS. CONTRACTORS SHALL VERIFY AND BE RESPONSIBLE FOR ALL DIMENSIONS AND CONDITIONS ON THE JOB. THE DESIGNER MUST BE NOTIFIED IMMEDIATELY OF ANY VARIATIONS FROM THE DIMENSIONS AND CONDITIONS SHOWN BY THESE DRAWINGS.

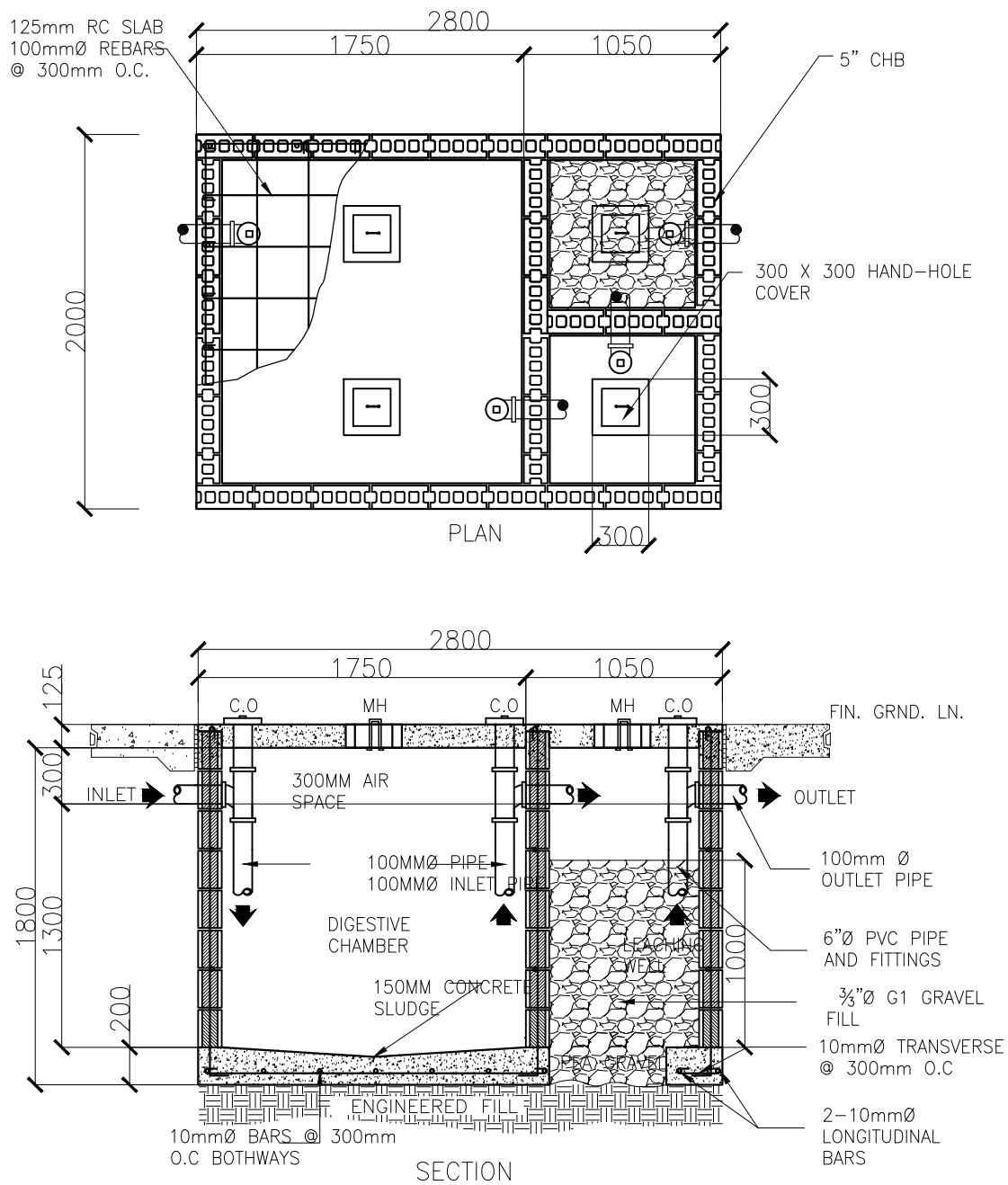

BATAAN PENINSULA STATE UNIVERSITY
TECHNICAL WORKING GROUP FOR INFRASTRUCTURE

CAPITOL COMPOUND, BRY. TENEKRO, CITY OF BALANGA, BATAAN,
E-MAIL: bpsu.techinfo2016@gmail.com/ bpsu2017@gmail.com/ bpsu2017@gmail.com
TELEPHONE NO. : (047) 237-15-08



SEPTIC TANK DETAILS
SCALE : _____ NTS.

SPECIFICATIONS		LEGEND	
PP-R POLYFUSION WELDED POLYPROPYLENE WATER PIPES SIZE AND SPECIFICATION:		SD	SHOWER DRAIN
NOMINAL SIZE		LAV	LAVATORY
mm	inches	WC	WATER CLOSET
20	3/4	FD	FLOOR DRAIN
25	1	CO	CLEAN OUT
32	1 1/4	UR	URINAL
40	1 1/2	WS	WASTE STACK
50	2	SS	SOIL STACK
CLASS: PN 20		VS	VENT STACK
CLEANOUT :		VSTR	VENT STACK THRU ROOF
SIZE OF PIPE		VSTC	VENT STACK THRU CEILING
DIAMETER		CWL	COLD WATER LINE
50 mm	50 mm (1 1/2")	CWR	COLD WATER RISER
50 mm	50 mm	CWDF	COLD WATER DOWN FEED
63 mm	63 mm	AC	AIR CHAMBER
90 mm	63 mm	KS	SERVICE SINK
110 mm	90 mm	TYP	TYPICAL
LARGER	90 mm	SMH	SEWER MANHOLE
DRAINAGE AND SOIL TREATMENT LINE MATERIAL SPECIFICATIONS : USE NELTEX OR EMERALD PVC PIPE AND FITTINGS		MH	MANHOLE
NOMINAL SIZE	OD		COLD WATER LINE
mm	mm		VENT PIPE
20	20	CB	CATCH BASIN
25	25	GD	GUTTER DRAIN
32	32	RD	ROOF DRAIN
50	50	TD	TRENCH DRAIN
63	57.15	CWP	COLD WATER PUMP
90	82.55	BP	BOOSTER PUMP
110	107.10	SP	SUMP PUMP
160	160	QTY	QUANTITY
ILLUSTRATION		TDH	TOTAL DYNAMIC HEAD
ITEM	ILLUSTRATED	HP	HORSE POWER
90° ELBOWS		RPM	REVOLUTION PER MINUTE
STRAIGHT TEE		KW	KILOWATT
REDUCING TEE			WASTE / SOIL PIPE
SANITARY TEE			WATER METER
P-TRAP			GATE VALVE
GATE VALVE			UNION
		GV	GATE VALVE
		CV	CHECK VALVE

GENERAL NOTES

1. ALL PLUMBING / SANITARY WORKS INCLUDE HEREIN SHALL BE EXECUTED ACCORDING TO THE PROVISIONS OF THE NATIONAL PLUMBING CODE OF THE PHILIPPINES (NPCP)(1999 REV., RA 1378) AND ITS IMPLEMENTING RULES AND REGULATIONS, APPLICABLE LAWS, CODES AND ORDINANCE.
2. ALL PLUMBING / SANITARY WORKS, INSTALLATIONS AND WORKSMANSHIP SHALL BE SUPERVISED BY A DULY LICENSED PLUMBING ENGINEER / MASTER PLUMBER.
3. ALL PIPES, FITTINGS, AND OTHER DEVICES SHALL BE INSTALLED AS INDICATED IN THE PLANS. ANY RELOCATION REQUIRED FOR EXECUTION OF OTHER TRADES SHALL BE PRIOR APPROVAL OF ENGINEER CONCERNED.
4. EXCAVATION, PIPE LAYING, AND BACKFILLING SHALL BE PERFORMED ACCORDING TO THE RECOMMENDED SLOPE AS PROVIDED IN SEC. 154 OF THE NATIONAL PLUMBING CODE OF THE PHILIPPINES (NPCP) WHICH STATES: ALL HORIZONTAL PIPING SHALL BE RUN IN PRACTICAL ALIGNMENT AND AT A UNIFORM GRADE OF NOT LESS THAN (2%) TWO PERCENT.
5. ALL PIPING SYSTEMS, IF NECESSARY SHALL BE SUPPORTED BY MEANS OF HANGERS, BRACES, CLAMPS, AND OTHER MEANS OF PIPE SUPPORTS. HORIZONTAL PIPES SHALL BE SUPPORTED AT INTERVALS NOT TO EXCEED 3048MM (10FT).
6. COLD WATER SUPPLY MATERIAL ALIKE SHALL BE PROTECTED BY ANY KIND OF MEANS, CONFORMED TO STANDARD PRACTICE REQUIRED BY SEC. 203 OF NPCP (1999 REV., RA 1378).
7. NO BUILDING / HOUSE COLD WATER SUPPLY (CWS) PIPE SHALL BE LESS THAN 13MM Ø (1/2" Ø) UNLESS OTHERWISE SPECIFIED.
8. SYSTEM OF TEST, ALL THE PIPING OF THE PLUMBING SYSTEM SHALL BE TESTED WITH WATER HAVING A PRESSURE HEAD OF AT LEAST 100PSI.
9. VENT THRU CEILING AND INDIVIDUAL VENT SHALL BE PROVIDED WITH AIR ADMITTANCE VALVES (AAV'S). IT SHALL PLACE ABOVE THE CEILING AND DRAIN LINE (P-TRAP) SIDE OF FIXTURE.
10. ALL ITEMS OR PARTS, SUCH AS FITTINGS, VALVES, FIXTURES, AND OR APPLIANCES ANY OTHER PLUMBING MATERIAL OR APPURTENANCES, WHETHER THESE PARTS HAVE BEEN SPECIFICALLY MENTIONED OR NOT INDICATED IN THE DRAWINGS , SHALL BE INSTALLED AND FURNISHED IF NECESSARY TO COMPLETE THE PLUMBING SYSTEM IN ACCORDANCE WITH THE BEST PRACTICE OF PLUMBING TRADE AND PROFESSION.
11. OWNER FURNISHED / SUPPLIED EQUIPMENT SHALL BE INSTALLED BY THE CONTRACTOR AS PER MANUFACTURES' / SUPPLIERS' REQUIRED INSTALLATION PROCEDURE, THE EXTENT OF CONTRACTOR'S RESPONSIBILITY ON THE INSTALLATION OF THE OWNER FURNISHED EQUIPMENT SHALL BE AT THE POINT OF CONNECTION AS INDICATED SUCH THAT INSTALLATION SHALL BE COMPLETED AND READY FOR USE BY THE OWNER.
12. PLUMBING FIXTURES, INCLUDING FAUCET AND FITTINGS. THE CONTRACTOR MUST SEE AND VERIFY THE OWNER OR ARCHITECT'S SPECIFICATIONS.
13. ALL ISOLATION VALVES SHALL BE LOCATED ABOVE FINISHED FLOOR LINE EXCEPT THOSE LOCATED IN VALVE BOXES.

CONVERSION OF ESF THIRD FLOOR BUILDING INTO BPSU COMMAND CENTER AT BPSU MAIN CAMPUS

BATAAN PENINSULA STATE UNIVERSITY
MAIN CAMPUS

STRUCTURAL ENGINEER

MASTER PLUMBER/SANITARY ENGINEER

PROFESSIONAL ELECTRICAL ENGINEER

PROFESSIONAL MECHANICAL ENGINEER

REVISION

DESCRIPTION	DATE

AR. ROXETTE S. UMEREZ
ARCHITECT 1, BPSU TWG HEAD FOR INFRASTRUCTURE

JASON ANTHONY B. BANZON
CAMPUS DIRECTOR

ENGR. ALFREDO D. VALENTOS
DIRECTOR, PPES

RECOMMENDED BY:

DR. EDMUNDO C. TUNGOL
VICE PRESIDENT ADMIN. & FINANCE

DR. GREGORIO J. RODIS
UNIVERSITY PRESIDENT

REPUBLIC ACT 9266.
NOTE: THIS DRAWING, AS AN INSTRUMENT OF SERVICE IS THE PROPERTY OF : BATAAN PENINSULA STATE UNIVERSITY AND AS SUCH MUST NOT BE REPRODUCED OR COPIED IN PART OR IN WHOLE WITHOUT THEIR PERMISSION ALL DRAWINGS ARE TO BE RETURNED WHEN NO LONGER IN USE.

SHEET CONTENT:	SHEET NUMBER:
THIRD FLOOR WATER LINE LAYOUT	P-MC-01
THIRD FLOOR SEWER LINE LAYOUT	